

Lancaster County Shore

C-20

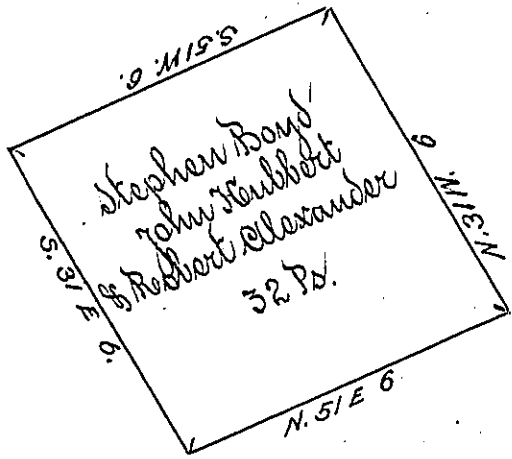

York County Shore

A Draught of Buck-wheat Island situate in Drumore Township Lancaster County between lands of Thomas Teill on the East and Big Bear Island on the West containing thirty two perches strict measure by the said John Heubbert by his release dated the 2nd day of August 1818 released all his right in said Island unto Joseph D. Boyd, surveyed in pursuance of a Warrant dated the 6th day of November A.D. 1818 granted to Stephen Boyd John Heubbert & Robert Alexander

To Jacob Spangler Esq. }
 Surveyor General }

Jacob Heibshman D.D.

IN TESTIMONY that the above is a copy of the original remaining on file in the Department of Internal Affairs of Pennsylvania, made conformably to an Act of Assembly approved the 16th day of February, 1833, I have hereunto set my Hand and caused the Seal of said Department to be affixed at Harrisburg, this twenty fifth day of January 1904.

James P. Brown
 Secretary of Internal Affairs.